





12A Bridge Street Waratah NSW

3  2  2 

Very solid brick veneer family home
3 excellent bedrooms
Huge kitchen
3 way bathroom
Spacious lounge that opens to a full width front veranda, producing suburban views
Downstairs there are 2 utility rooms (ideal for many uses)
Double garage and huge workshop area
Laundry and 2nd WC
This home has enormous potential
HIGHLY RECOMMENDED

Price : \$ 550,000
Land Size : 445 sqm
View : <https://www.crawfordrealestate.com.au/sale/nsw/newcastle-region/waratah/residential/house/5661406>



Robert Crawford
02 4957 6166



Upper Floor Plan
Total Internal Floor Area: 245 sqm

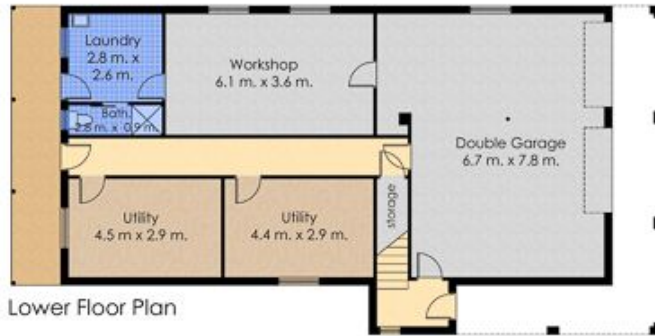

Lower Floor Plan



Site Plan
Not to Scale



Measurements and direction of north are approximate and are to be used as a guide only.