



**2/16 Bambara Close Lambton NSW**

2 1 1

This stylish 2 bedroom Brick Veneer and Tile Villa is sure to impress. Recently given a full makeover the property has been refreshed with Neutral décor, new carpet, renovated kitchen and bathroom and Plantation Shutters.

Both bedrooms are a generous size and feature built-in wardrobes, ceiling fan lights and Shutters. Updated bathroom features new frameless glass shower screen, a bath, new vanity and a separate WC with hand basin.

The new kitchen features black glass splashbacks, fresh white cabinetry, and stainless steel appliances including dishwasher, pantry and new laminate flooring. The rear deck is ideal for an afternoon cuppa on a cool winter afternoon and the generous grassed courtyard is fully fenced with side gate.

Internal laundry off the kitchen with industrial style sliding door and access to the garage.

Situated in a small boutique complex of 4 in a quiet cul-de-sac in a leafy environment with parks and walking tracks nearby. Convenient location for access to the local

**Land Size** : 175 sqm  
**View** : <https://www.crawfordrealestate.com.au/lease/nsw/newcastle-region/lambton/residential/villa/5661720>



**Kerry Robertson**  
02 4957 6166



**Amanda Swan**  
02 4957 6166

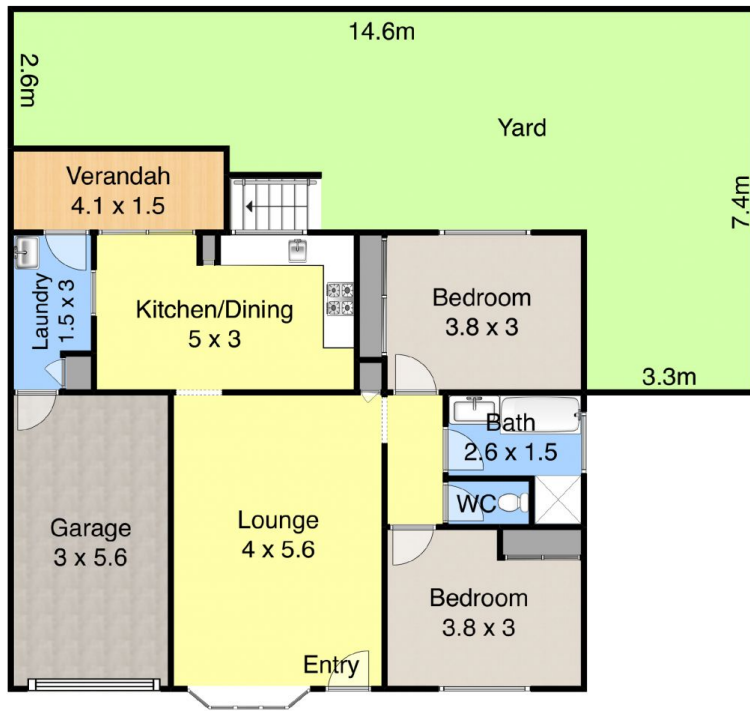

**2/16 Bambara Close,  
Lambton**



Measurements are approximate and are to be used as a guide only

