



### 127 Russell Road New Lambton NSW

3 1 1

Set back from the road, this cosy 3 bedroom weatherboard home is quiet and private with a large north facing balcony at the rear to entertain friends and family or to just sit back, relax and indulge in the spectacular view out over New Lambton, surrounding suburbs with views all the way to the ocean.

#### Featuring:

- ? 3 bedrooms, all with ceiling fans, picture rails and original ornate ceilings
- ? Tidy galley style kitchen with electric Euromaid upright stove and ample storage
- ? Split system air conditioning in both the front sunroom and rear living area
- ? Family bathroom with separate shower and bath
- ? Rear lane access from Owen Lane provides extra parking opportunities.

Located within the zone for the highly sought-after New Lambton public school and Lambton high school and close proximity to John Hunter Hospital, New Lambton Shopping Village, transport and Westfield Kotara just minutes away,

**Land Size** : 500 sqm

**View** : <https://www.crawfordrealestate.com.au/lease/nsw/newcastle-region/new-lambton/residential/house/7302334>



**Amanda Swan**  
02 4957 6166

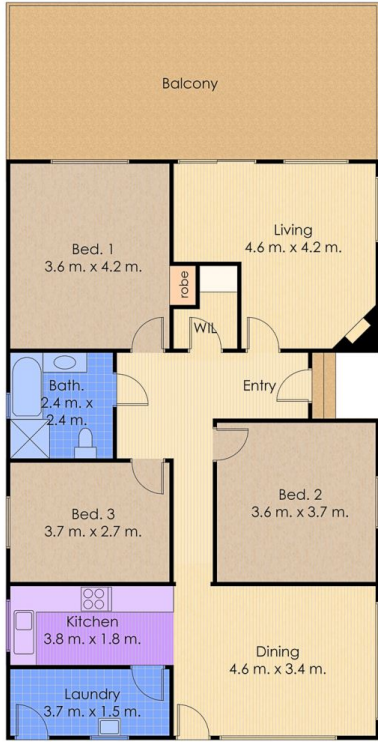

Total Approx. Internal Floor Area: 174 sqm

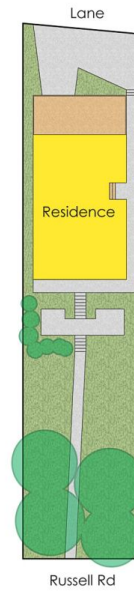
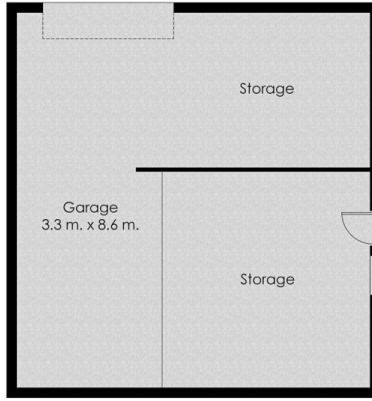

Not to Scale



127 Russell Rd  
New Lambton

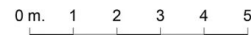

Measurements and direction of north are approximate and are to be used as a guide only.